



APE SERVICE BULLETIN

DEEP FOUNDATION SOLUTIONS

VIBRATORY HAMMER • POWER UNIT • AUGER SYSTEMS • DIESEL & HYDRAULIC HAMMERS
• DRILL RIGS • HYDRAULIC PILING RIGS • WICK DRAIN INSTALLERS • LEAD SYSTEMS



#47 BATTERY DISCONNECT UPDATE

If the Power unit is equipped with an Electronic Control Panel, you will need to install a battery disconnect.

Requirements:

1. 2004397: Switch Battery Disconnect-PU
2. 2004410: C18-C32 Battery Disconnect Bracket
3. C27-C32 will use existing Negative battery cable
4. Extra battery lug (C27-C32 only)
5. P/n: Battery Disconnect Wiring kit
6. 2003961: - Battery Disconnect Decal

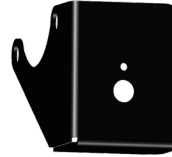

Battery disconnect Bracket



Switch Battery disconnect

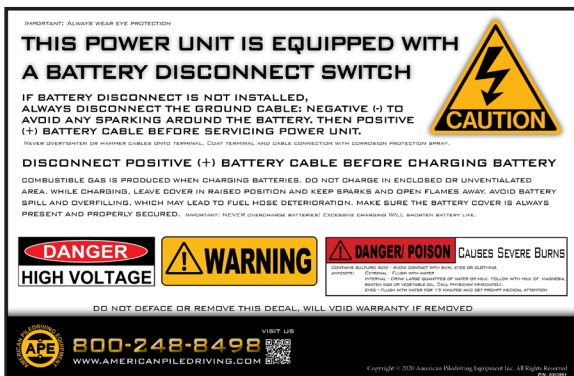

Battery Disconnect Decal

Battery Connected



Battery Disconnected



Note: Use Locked out Tag when necessary "DO NOT OPERATE"



800-248-8498
WWW.AMERICANPILEDIVING.COM

VISIT US



MOBILE APP
NOW AVAILABLE

